

# Blackburn Compression

Featuring the Color-Keyed® System

CATALOG NO. 54970BEPH

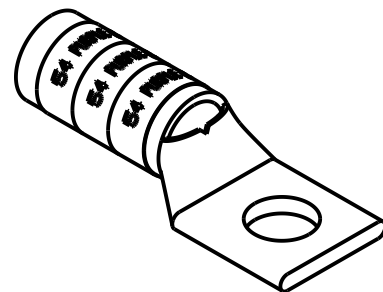
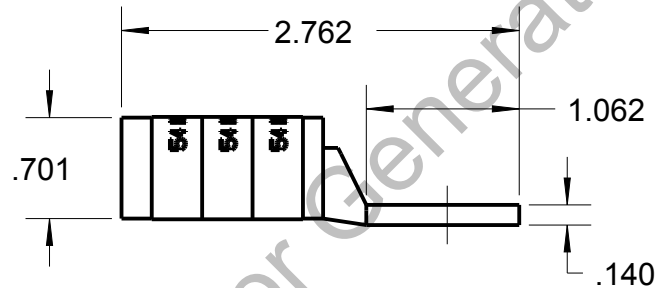
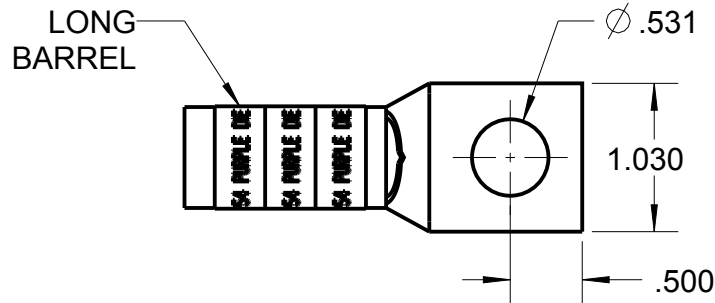

WIRE SIZE: 4/0  
 MATERIAL: HIGH CONDUCTIVITY COPPER  
 FINISH: TIN PLATED

GENERAL NOTES		<div><div>Thomas &amp; Betts</div><div>www.tnb.com</div></div>			
1. ALL DIMENSIONS ARE FOR REFERENCE ONLY. 2. DIMENSIONS IN BRACKETS [ ] ARE IN METRIC UNITS.					
REVISIONS		DESCRIPTION:  1 HOLE LUG			
**	SEE ERN ( **** ) FOR APPROVAL SIGNATURES & RELEASE DATE. PROJECT NO: ****	ORIGINAL PROJECT NO / ( ERN NO )  / ( )	SHEET NO:  1 OF 1	REV. NO:  0	DRAWING NO: WSD-003062  54970BEPH