

DATA SHEET	19121000
EPIC[®] H-B 24 TG	Valid from: 31.07.2015

Description

- Ideal for many applications due to a wide range of housings and inserts



General Characteristics

Series	H-B 24
Version	Hood M25/ M32 (Article 19111000)
Locking	Bolts for double lever
Cable gland	No
Cable entry	Straight
Protection	IP 65(latched)
Temperature Range	-40°C to +100°C, short term up to +125°C

Materials and Surfaces

Housing	powder-coated aluminium alloy, grey
Bolts	Zinc-plated steel

Approvals

VDE-Approval, VDE-REG.-Nr.	B437
----------------------------	------

Standard

Product Standard	IEC 61984
------------------	-----------

DATA SHEET	19121000
EPIC® H-B 24 TG	Valid from: 31.07.2015

Technical Drawings

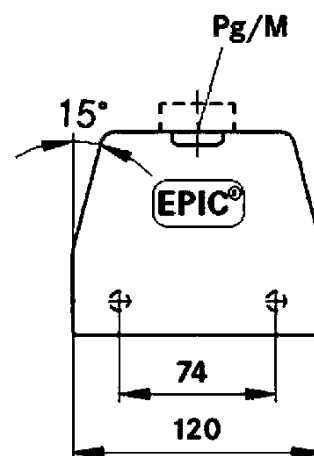
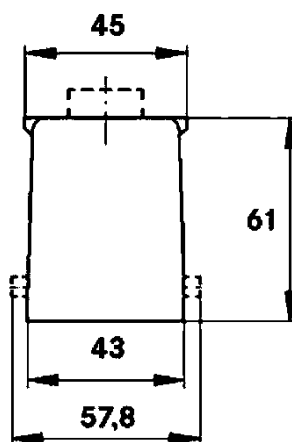

Automation



Industrial machinery and plant engineering



Mechanical resistance



Robust



Waterproof

Info

Universal, robust metal housings size H-B 24

Application range

Plant engineering
Light & sound technology
Plastics industry

Remark

Photographs are not to scale and do not represent detailed images of the respective products.

Creator: MANU2/PDP Released: IVSE1/PDP	Document: DB19121000EN Version: 00	Page 2 of 2
---	---------------------------------------	-------------