

# Product End of Life Instructions

## ILM62DB Distribution Box

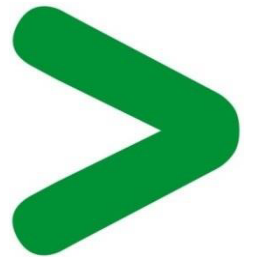



## Potential disassembly risks

*ELECTROLYTIC CAPACITORS to be disassembled with caution*



## End of Life Instructions

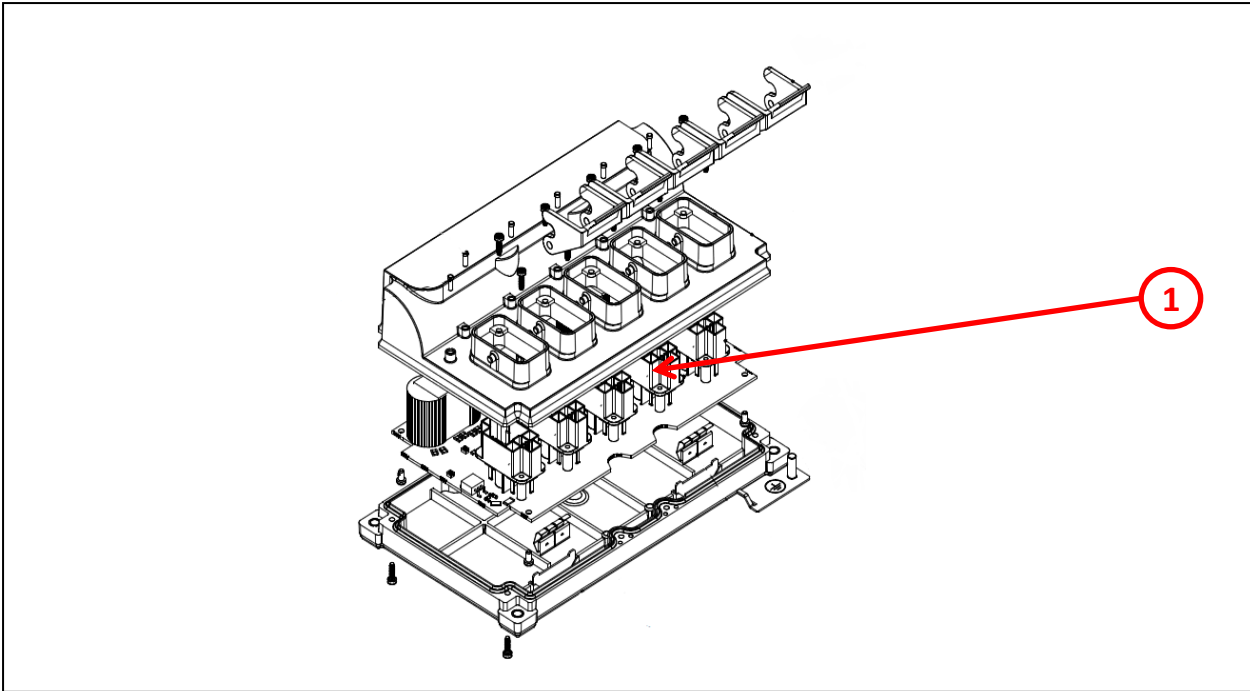

Recommendation	Number on drawing	Component / Material	Weight (in g)	Comment
To be depolluted	1	Electronic Board (Power) > 10cm <sup>2</sup>	273	



## Product description

Manufacturer identification	Schneider Electric Industries SAS
Brand name	Schneider Electric
Product function	The Distribution Box ILM62DB is the link between the Connection Module ILM62CM and the ILM62 Servo Module. Depending on the number of drives, 1 to 4 ILM62 Servo Modules or daisy chain lines can be connected. When operating more than 4 drives, the system can be simply expanded using one or more Distribution Box ILM62DB.
Product reference	ILM62DB4A000
Total representative product mass	844 g
Representative product dimensions	94mm x 230mm x 151,4mm
Date of information release	09/2018



## Additional information

Legal information	The product family must be disposed according to the legislation of the country. This document is intended for use by end of life recyclers or treatment facilities. It provides the basic information to assure an appropriate end of life treatment for the components and materials of the product.	
Recyclability potential	<b>28%</b>	Based on "ECO'DEEE recyclability and recoverability calculation method" (version V1, 20 Sep. 2008 presented to the French Agency for Environment and Energy Management: ADEME).

Schneider Electric Industries SAS  
Country Customer Care Center  
<http://www.schneider-electric.com/contact>

35, rue Joseph Monier  
CS 30323  
F- 92506 Rueil Malmaison Cedex  
RCS Nanterre 954 503 439  
Capital social 896 313 776 €

[www.schneider-electric.com](http://www.schneider-electric.com)

ENVEOLI1407007EN\_V2

Published by Schneider Electric

© 2018 - Schneider Electric – All rights reserved

09/2018