

Product End of Life Instructions

Modicon TM - Compact 24Vdc 24DI/18DO

Compact I/O expansion block, Modicon TM5

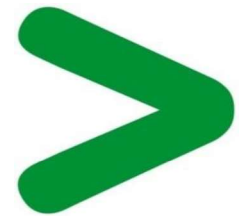

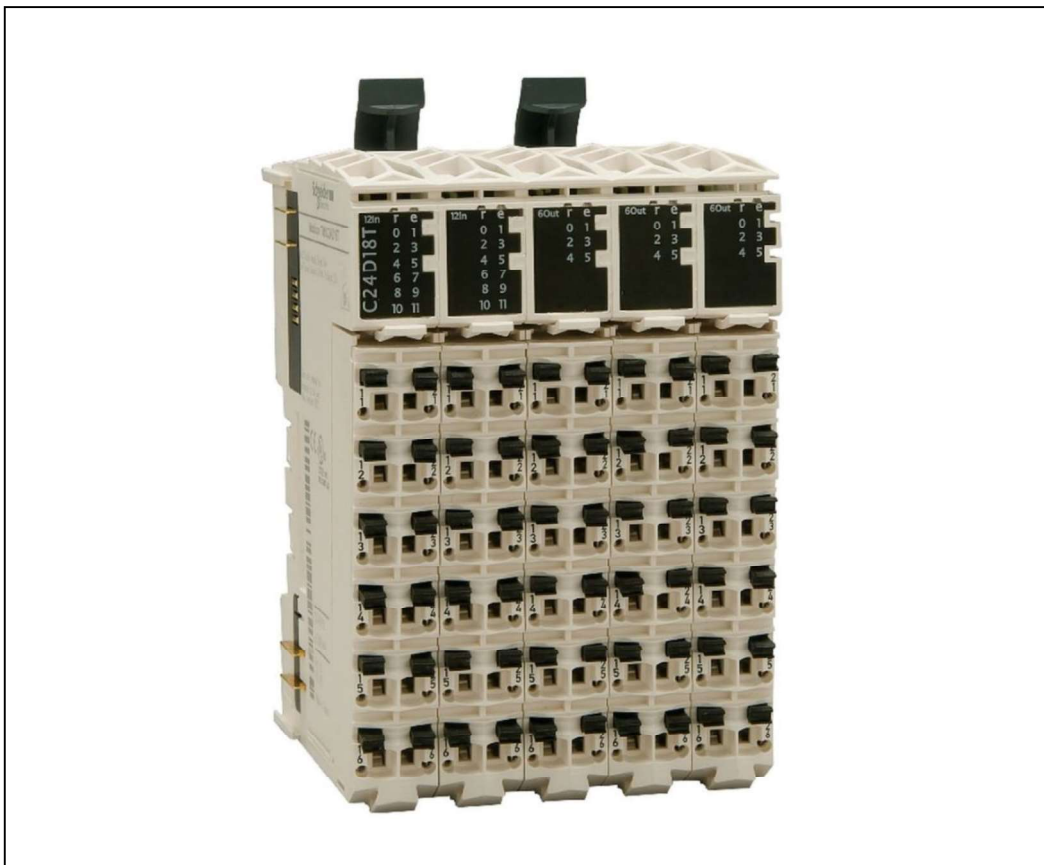

Potential disassembly risks

The information provided in this document assumes that the product is completely de-energized and uninstalled (refer to the instructions provided in the appropriate product manuals).

Dismantling/disassembling the product may entail hazards caused by, for example, sharp edges, chemical aggression or ejected parts.

⚠ WARNING

HAZARD DUE TO INSUFFICIENT PROTECTION

- Implement all safety measures required by the applicable regulations and by the processes used to dismantle/disassemble and dispose of the product.
- Use all necessary personal protective equipment such as gloves and goggles.

Failure to follow these instructions can result in death or serious injury.



End of Life Instructions

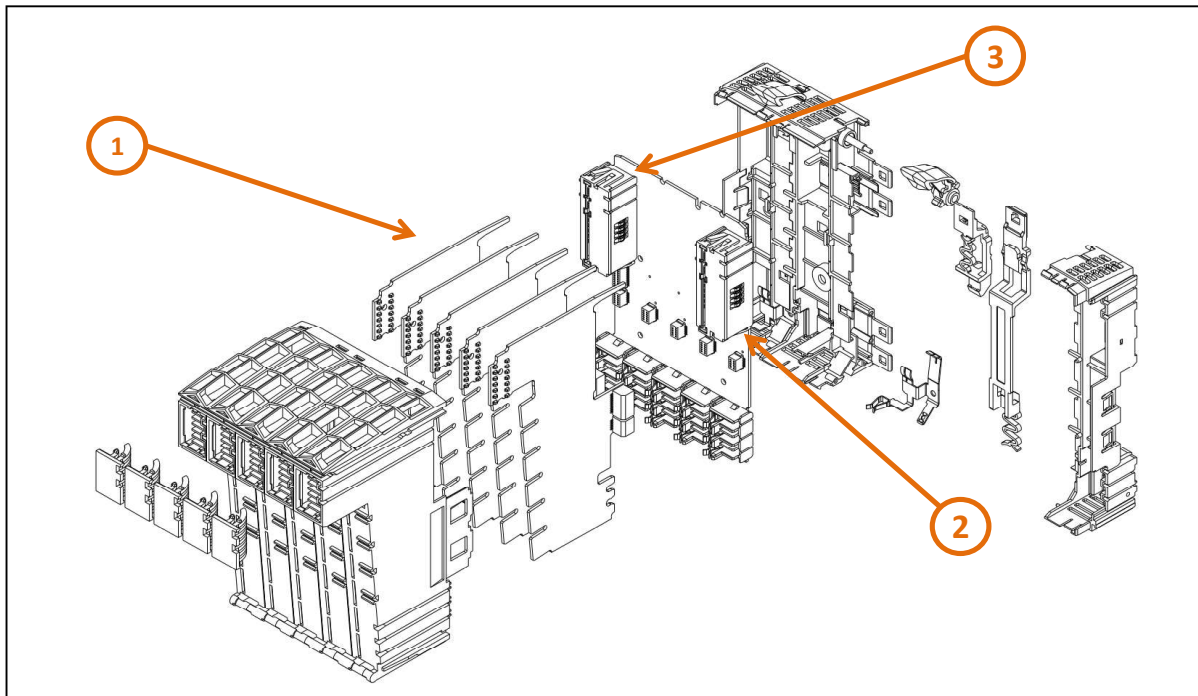

Recommendation	Number on drawing	Component / Material	Weight (in g)	Comment
To be depolluted	1	Electronic Board (Power) > 10cm ²	45,6	5 electronic boards
To be depolluted	2	Electronic Board (Power) > 10cm ²	45,3	Electronic board in a block
To be depolluted	3	Electronic Board (Power) > 10cm ²	63,5	Electronic board in a block
Other			210,4	

Product description

Manufacturer identification	Schneider Electric Industries SAS
Brand name	Schneider Electric
Product function	The product is a compact I/O expansion block for Modicon TM5 Terminal Block. It consist of a single unit comprising electronic cards, bus bases and a plug-in connection terminals. It is having 24 analog or digital I/O adapted to a 24V DC, 3,75 mA current.
Product reference	TM5C24D18T
Additional similar product references	TM5C24D18T TM5C12D8T TM5C24D12R
Total representative product mass	364,8 g
Representative product dimensions	75 mm x 90 mm x 110 mm
Accessories	No
Date of information release	19/01/2026

Additional information

Legal information	This product family is in the scope of European Union directive 2012/19/EU on Waste Electrical and Electronic Equipment (WEEE). The product family must be disposed according to the legislation of the country. This document is intended for use by end of life recyclers or treatment facilities. It provides the basic information to assure an appropriate end of life treatment for the components and materials of the product.
In case of special transportation: transportation method	No special transportation
Recyclability potential	1% The recyclability rate was calculated from the recycling rates of each material making up the product based on REEECYLAB tool developed by Ecosystem, for components/materials not covered by the tool, data from the EIME database and the related PSR was taken. If no data was found a conservative assumption was used (0% recyclability).

Schneider Electric Industries SAS

Country Customer Care Center
<http://www.se.com/contact>

35, rue Joseph Monier
 CS 30323
 F- 92500 Rueil Malmaison Cedex
 RCS Nanterre 954 503 439
 Capital social 928 298 512 €

www.se.com

ENVEOLI1511024_V2

Published by Schneider Electric

© 2025 - Schneider Electric – All rights reserved

19/01/2026