

Product End of Life Instructions

CANopen I/O block 16 M8

Modicon TM7 - IP67 Distributed I/O





Potential disassembly risks

The information provided in this document assumes that the product is completely de-energized and uninstalled (refer to the instructions provided in the appropriate product manuals).

Dismantling/disassembling the product may entail hazards caused by, for example, sharp edges, chemical aggression or ejected parts.

⚠ WARNING

HAZARD DUE TO INSUFFICIENT PROTECTION

- Implement all safety measures required by the applicable regulations and by the processes used to dismantle/disassemble and dispose of the product.
- Use all necessary personal protective equipment such as gloves and goggles.

Failure to follow these instructions can result in death or serious injury.



End of Life Instructions

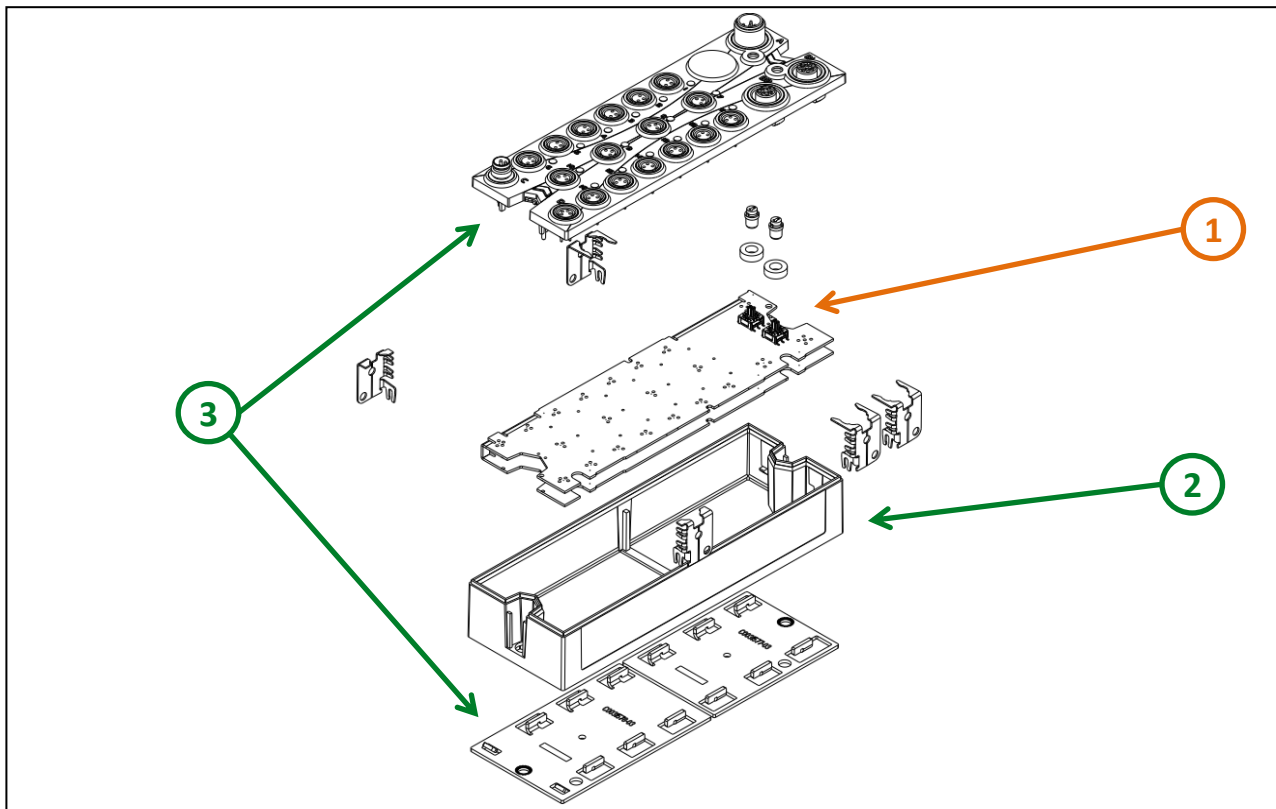

Recommendation	Number on drawing	Component / Material	Weight (in g)	Comment
To be depolluted	1	Electronic Board (Communication) greater than 10cm ²	112,5	
To be dismantled	2	PA polyamide	180	Case
To be dismantled	3	Aluminium	27	Shielding hood
Other		Plastics, metals and semimetals	30,9	

Product description

Manufacturer identification	Schneider Electric Industries SAS
Brand name	Schneider Electric
Product function	This CANopen island head includes 16 configurable digital I/O channels distributed across 16 M8 connectors. It can be installed as close as possible to equipment in harsh environments. Modicon TM7 CANopen interface block enables sensors and actuators distributed across machines to be connected via the CANopen fieldbus. This interface block communicates on the bus.
Product reference	TM7NCOM16B
Additional similar product references	TM7NCOM16B TM7BDI16A TM7BDI16B TM7BDI8B TM7BDM16A TM7BDM16B TM7BDM8B TM7BDO8TAB TM7SDI8DFS TM7SDM12DTFS TM7NCOM08B TM7NCOM16A TM7SPS1A TM7BAI4CLA TM7BAI4PLA TM7BAI4TLA TM7BAI4VLA TM7BAM4CLA TM7BAM4VLA TM7BAO4CLA TM7BAO4VLA
Total representative product mass	350,4 g
Representative product dimensions	155mm x 53mm x 42mm
Accessories	No
Date of information release	20/12/2025

Additional information

Legal information	This product family is in the scope of European Union directive 2012/19/EU on Waste Electrical and Electronic Equipment (WEEE). The product family must be disposed according to the legislation of the country. This document is intended for use by end of life recyclers or treatment facilities. It provides the basic information to assure an appropriate end of life treatment for the components and materials of the product.
In case of special transportation: transportation method	No special transportation
Recyclability potential	10% The recyclability rate was calculated from the recycling rates of each material making up the product based on REEECYLAB tool developed by Ecosystem, for components/materials not covered by the tool, data from the EIME database and the related PSR was taken. If no data was found a conservative assumption was used (0% recyclability).

Schneider Electric Industries SAS

Country Customer Care Center
<http://www.se.com/contact>

35, rue Joseph Monier

CS 30323

F- 92500 Rueil Malmaison Cedex

RCS Nanterre 954 503 439

Capital social 928 298 512 €

www.se.com

ENVEOLI1409005_V2

Published by Schneider Electric

© 2025 - Schneider Electric – All rights reserved

20/12/2025