

Product data sheet

Specifications

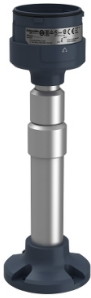

Fixing plate with adjustable aluminium pole 210 to 385mm for modular tower lights, Harmony XVU, black, 60mm

XVUZ05

⚠ To be discontinued on: May 31, 2026

⚠ To be discontinued

Main

| | |
|------------------------------------|-------------------------------|
| Range of product | Harmony XVU |
| Product or component type | Modular tower light |
| Accessory / separate part type | Adjustable pole |
| Accessory / separate part category | Mounting and fixing accessory |
| Component name | XVU |
| Mounting diameter | 60 mm |

Complementary

| | |
|---------------------------|--------------------------------------------------------------------------------------------------------------------------------------|
| Pole height | 210...385 mm |
| Mounting support | Plate with adjustable pole |
| Product compatibility | Top: DC body |
| Material | PBT (polybutylene terephthalate) V-0 conforming to UL 94 ABS (acrylonitrile butadiene-styrene) PC (polycarbonate) Aluminium |
| Housing colour | Black |
| Connections - terminals | Push-in |
| [Us] rated supply voltage | 24 V AC/DC |
| Length | 209.7...384.7 mm |
| Net weight | 0.253 kg |

Environment

| | |
|---------------------------------------|-----------------|
| Ambient air temperature for storage | -40...70 °C |
| Ambient air temperature for operation | -25...50 °C |
| IP degree of protection | IP65 |
| Product certifications | UL CE CSA |

Packing Units

| | |
|------------------------------|-----|
| Unit Type of Package 1 | PCE |
| Number of Units in Package 1 | 1 |

| | |
|-------------------------------------|-----------|
| Package 1 Height | 9.200 cm |
| Package 1 Width | 9.300 cm |
| Package 1 Length | 27.000 cm |
| Package 1 Weight | 416.000 g |
| Unit Type of Package 2 | S03 |
| Number of Units in Package 2 | 12 |
| Package 2 Height | 30.000 cm |
| Package 2 Width | 30.000 cm |
| Package 2 Length | 40.000 cm |
| Package 2 Weight | 5.963 kg |
| Unit Type of Package 3 | P06 |
| Number of Units in Package 3 | 96 |
| Package 3 Height | 77.000 cm |
| Package 3 Width | 60.000 cm |
| Package 3 Length | 80.000 cm |
| Package 3 Weight | 48.320 kg |



Environmental Data

Schneider Electric aims to achieve Net Zero status by 2050 through supply chain partnerships, lower impact materials, and circularity via our ongoing “Use Better, Use Longer, Use Again” campaign to extend product lifetimes and recyclability.

[Environmental Data explained >](#)

[How we assess product sustainability >](#)

Environmental footprint

Total lifecycle Carbon footprint 2

Environmental Disclosure [Product Environmental Profile](#)

Use Better

Materials and Substances

Packaging made with recycled cardboard Yes

Packaging without single use plastic Yes

[EU RoHS Directive](#) Pro-active compliance (Product out of EU RoHS legal scope)

SCIP Number C06fce4f-aea2-46a5-aadb-0b38d1efbe3f

California proposition 65 **WARNING:** This product can expose you to chemicals including: Lead and lead compounds, which is known to the State of California to cause cancer and birth defects or other reproductive harm. For more information go to www.P65Warnings.ca.gov

Use Again

Repack and remanufacture

End of life manual availability [End of Life Information](#)

Take-back No

Dimensions Drawings

Fixing Unit - Plate with Adjustable Pole

Dimensions

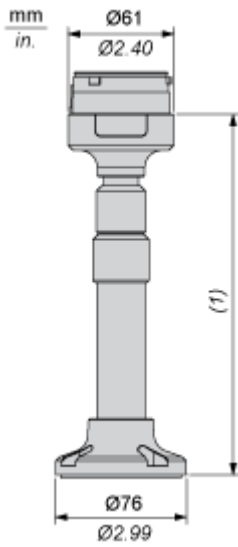

(1) adjustment:209.7 ... 384.7 or adjustment:8.256 ... 15.146

Mounting and Clearance

Modular Tower Lights Mounting

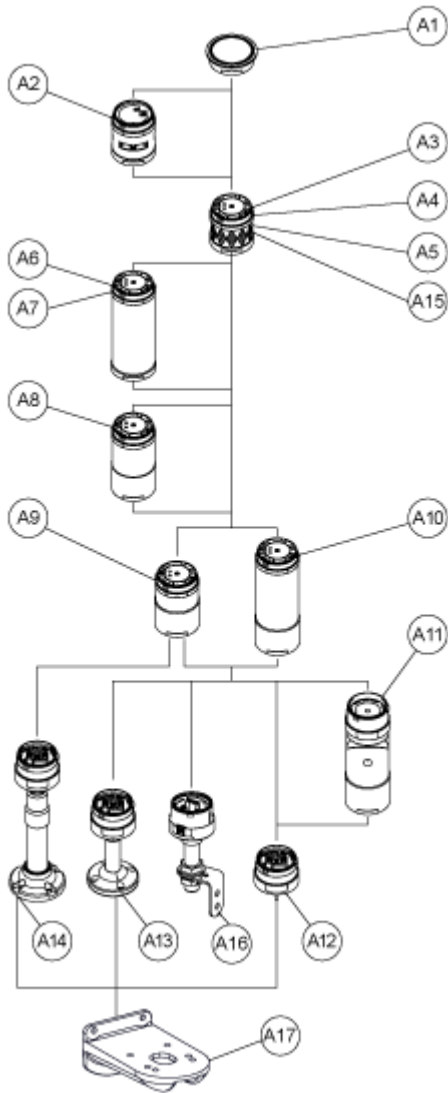

| Drawing | Part number | Part name |
|---------|-------------|----------------------|
| A1 | - | Top cover |
| | - | Top cover (Silver) |
| A2 | XVUC9S | Buzzer unit |
| | XVUC9SQ | Buzzer unit (Silver) |
| A3 | XVUC23 | Green LED unit |
| | XVUC24 | Red LED unit |
| | XVUC25 | Orange LED unit |
| | XVUC26 | Blue LED unit |

| Drawing | Part number | Part name |
|---------|-------------|-------------------------------------------------------|
| | XVUC27 | White LED unit |
| | XVUC28 | Yellow LED unit |
| A4 | XVUC29 | Multi-LED unit |
| A5 | XVUC29P | Multi-LED unit, Pulse signal |
| A6 | XVUC9V | Sound unit |
| A7 | XVUC9VP | Sound unit, Pulse signal |
| A8 | XVUC020 | Extender |
| | XVUC020Q | Extender (Silver) |
| A9 | XVUC21B | DC body |
| | XVUC21BQ | DC body (Silver) |
| A10 | XVUC21M | AC body NPN |
| | XVUC21MP | AC body PNP |
| | XVUC21MQP | AC body PNP (Silver) |
| A11 | XVUZ06 | Flexible option |
| A12 | XVUZ01 | Fixing Unit - Direct mounting (3 pins) |
| | XVUZ01Q | Fixing Unit - Direct mounting (Silver,3 pins) |
| | XVUZ03 | Fixing Unit - Direct mounting (2 pins) |
| | XVUZ04 | Fixing Unit - Direct mounting (4 pins) |
| A13 | XVUZ02 | Fixing Unit - Plate with Pole (100 mm) |
| | XVUZ02Q | Fixing Unit - Plate with Pole (100 mm, Silver) |
| | XVUZ400 | Fixing Unit - Plate with Pole (400 mm) |
| | XVUZ800 | Fixing Unit - Plate with Pole (800 mm) |
| A14 | XVUZ05 | Fixing Unit - Plate with adjustment pole (100-385 mm) |
| A15 | XVUC43 | Green LED unit, Flash |
| | XVUC44 | Red LED unit, Flash |
| | XVUC45 | Orange LED unit, Flash |
| | XVUC46 | Blue LED unit, Flash |

| Drawing | Part number | Part name |
|------------|-------------|--------------------------------------------------|
| | XVUC47 | White LED unit, Flash |
| | XVUC48 | Yellow LED unit, Flash |
| A16 | XVUZ100T | Fixing Unit - Metal bracket with pole (100 mm) |
| | XVUZ250T | Fixing Unit - Metal bracket with pole(250 mm) |
| | XVUZ400T | Fixing Unit - Metal bracket with pole (400 mm) |
| A17 | XVUZ12 | Fixing plate for use on vertical support - black |

Connections and Schema

Illuminated Units, Multi-LED and Audible Units Wiring

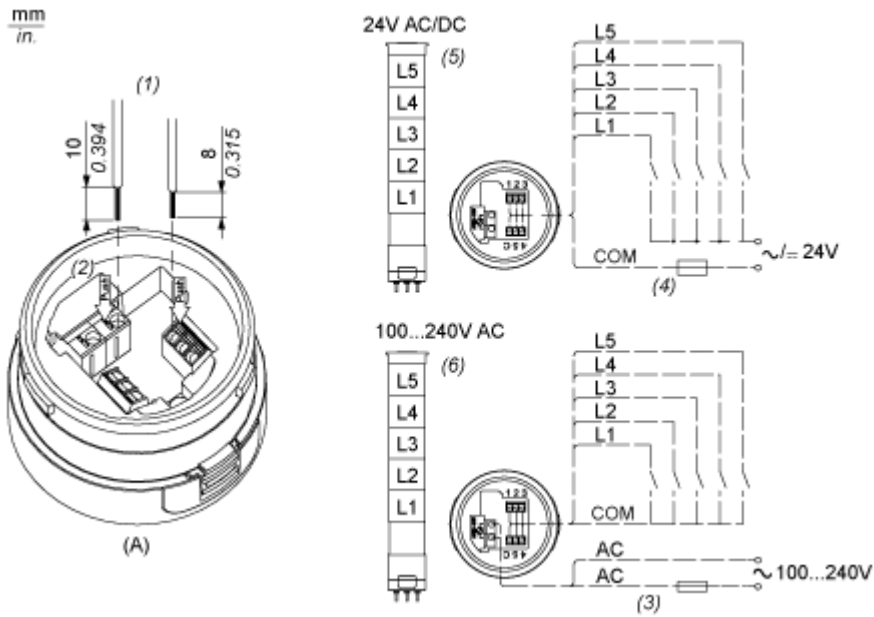

- (A) Fixing Unit
 - (1) Dimensions of Wiring size
 - (2) Push-in Wire Connectors
 - (3) Fuse : 2A ,250V
 - (4) Fuse : 0.5A ,125V
 - (5) Modular Tower Lights 24V AC/DC
 - (6) Modular Tower Lights 100...240V AC
- L1 to L5 : Illuminated LED Units

Technical Illustration

Dimensions

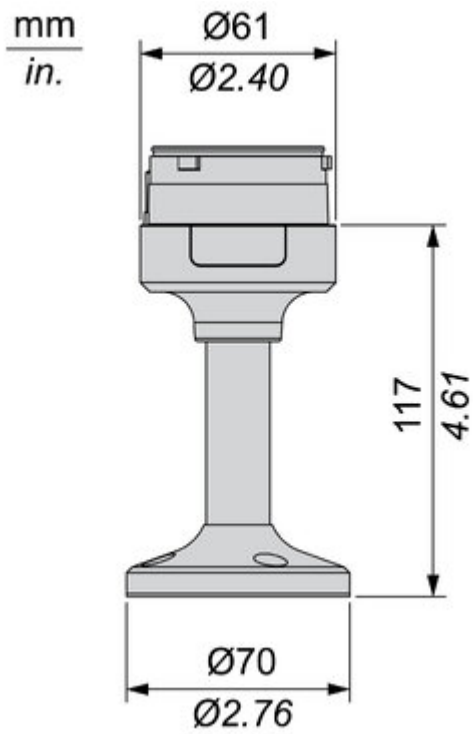

Technical Illustration

Wiring diagram

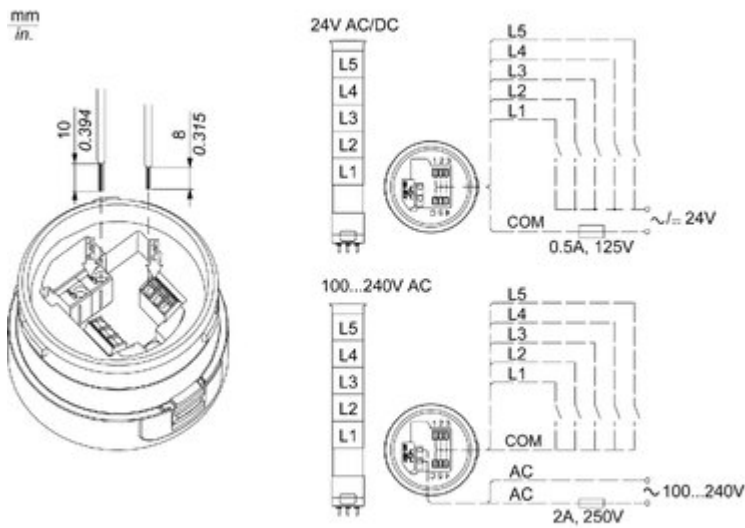

Offer Marketing Illustration

Product benefits / Features

功能特点

Harmony XVU 模块式信号灯柱



单色 LED 发光单元:6 色可选;
多色 LED 发光单元:旋钮手
调或者 PLC 信号控制,可发
出多种颜色光,多种闪烁模式



模块化结构 客户自行组装,
可组合最多 5 个发光单元
或 4 个发光 +1 个发声单元





水平安装:使用直接安装底座、
支撑杆安装底座或可伸缩支撑
杆安装底座固定到安装面板上;
竖直安装:使用带 L 支架支撑杆
安装底座或添加墙装支架固定
到竖直安装面板上



安装简化,维护方便,
可直接连接 PLC



使用免费的语音编辑软件在电脑上定
制语音,再通过 SD 卡复制到设备中,
多个通道可输出。

Image of product / Alternate images

Alternative



